

BEVERAGE-AIR

KR/KF 12/24/36/48/74



PARTS

MANUAL

CABINET COMPONENTS KF24/36/48/74

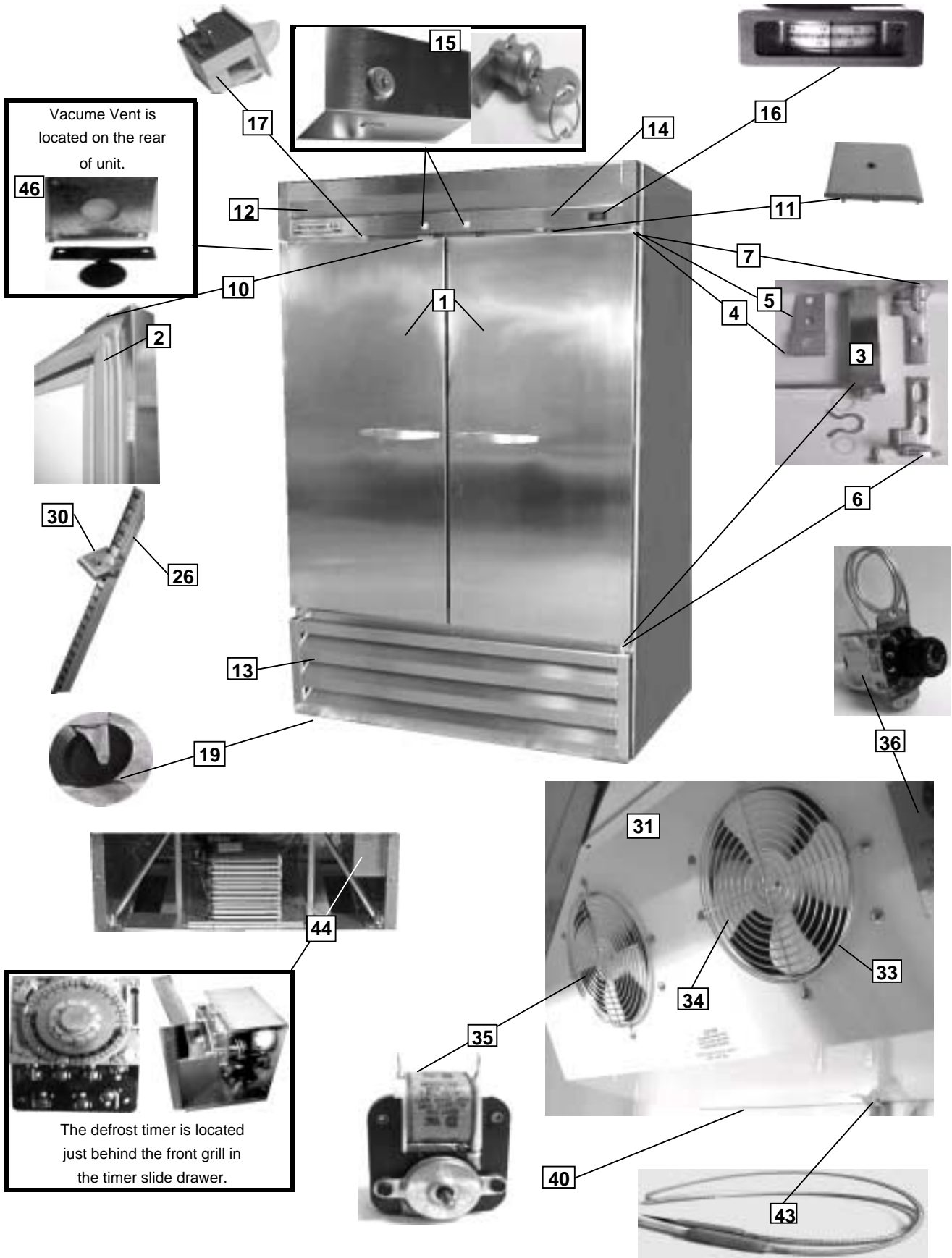

EVAPORATOR COIL ASSY.

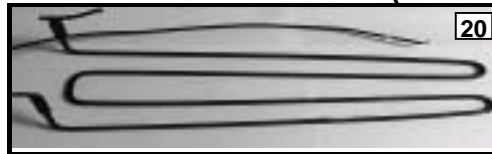
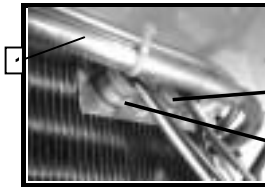
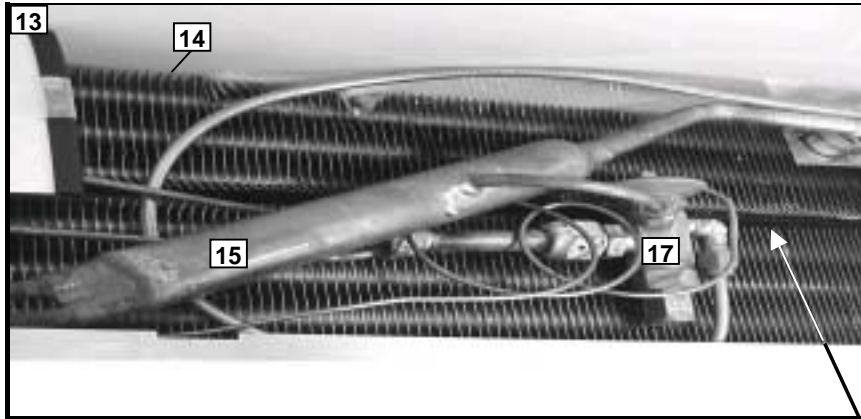

CONDENSING UNIT ASSEMBLY

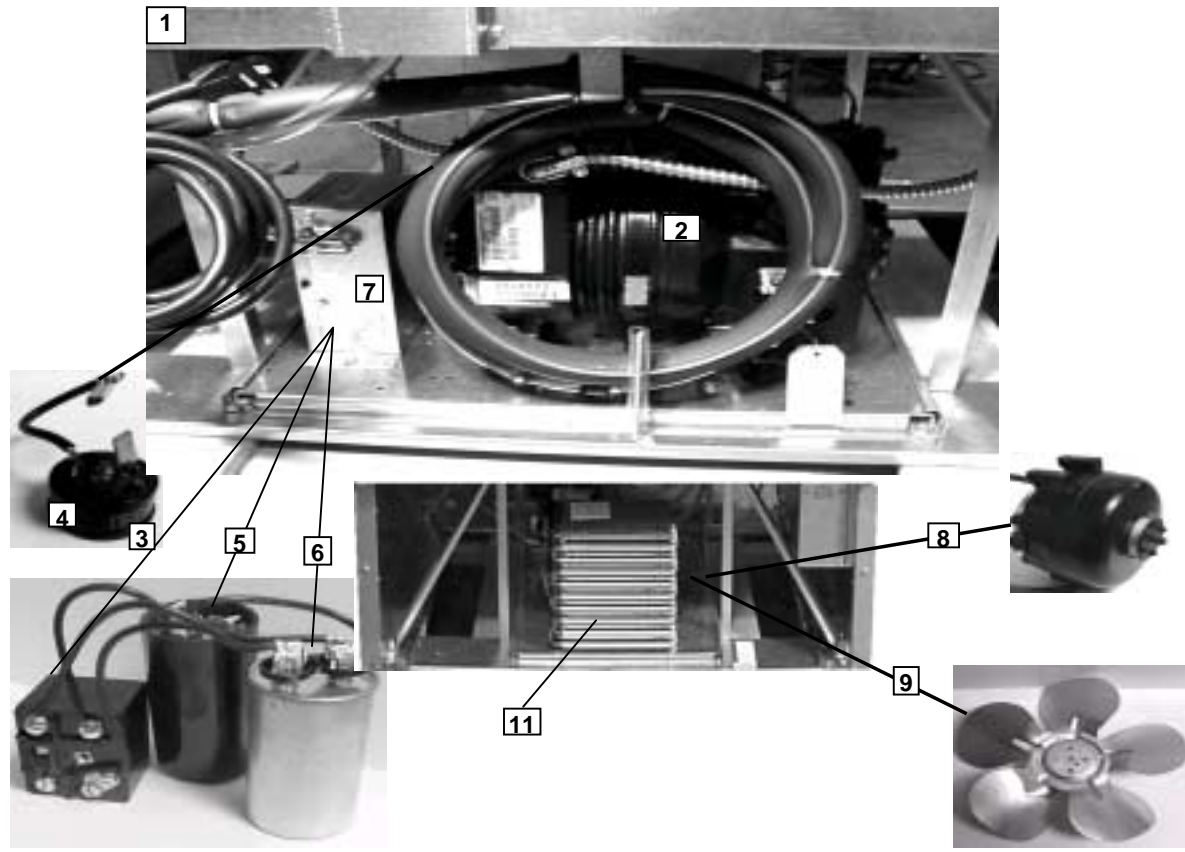

CABINET COMPONENTS
KR/KF12/24/36/48/74

ITEM	MODEL	DESCRIPTION	PART NUMBER
1	KR/KF12	DOOR ASSY. (R.H.)	40B48-008D-06
	KR/KF24/48/74	DOOR ASSY. (R.H.)	40B48-036D-01
	KR/KF36	DOOR ASSY. (R.H.)	40B48-048D-01
	KR/KF36	DOOR ASSY. (L.H.)	40B48-047D-01
	KR/KF48/74	DOOR ASSY. (R.H.)	40B48-035D-01
	KR/KF74	DOOR ASSY. (CTR)	40B48-036D-01
2	KR/KF12	DOOR GASKET	712-005C-08
	KR/KF24/36/48/74	DOOR GASKET	703-988C-01
3	ALL	DOOR SPRING	401-216A-01
4	ALL	DOOR BUSHING (TOP)	401-248A
5	ALL	DOOR BUSHING RETAINER	59D45-009B
6	ALL	HINGE BRKT BOT RH CHROME	401-220A-01
7	ALL	HINGE BRKT TOP RH CHROME	401-246A-01
8	KR/KF48/74	HINGE BRKT (BOTTOM L.H.)	401-219A-01
9	KR/KF48/74	HINGE BRKT (TOP L.H.)	401-247A-01
10	KR/KF24/36/48/74	DOOR LOCK GUARD	40A37-057B-05
11	KR/KF24/36/48/74	STRIKE PLATE (SWITCH)	60D32-017B
12	KR/KF24	TOP GRILL	44B31-246C-05
	KR/KF36	TOP GRILL	44B31-246C-02
	KR/KF48	TOP GRILL	44B31-246C-07
	KR/KF74	TOP GRILL	44B31-246C-08
13	KR/KF12	BOTTOM GRILL	44B31-227C
	KR/KF24	BOTTOM GRILL	44B31-252C-02
	KR/KF36	BOTTOM GRILL	44B31-253C-02
	KR/KF48	BOTTOM GRILL	44B31-254C-02
	KR/KF74	BOTTOM GRILL	44B31-255C-02
14	KR/KF24	INST. PANEL	50B36-084C-03
	KR/KF36	INST. PANEL	50B36-085C-03
	KR/KF48	INST. PANEL	50B36-086C-03
	KR/KF74	INST. PANEL	50B36-087C-03
15	KR/KF24/36/48/74	LOCK WITH KEY	401-510A
16	KR/KF24/36/48/74	THERMOMETER-DRUM	402-218B
	KR/KF12	THERMOMETER	402-243A
17	KR/KF24/36/48/74	ROCKER SWITCH	502-198A
18	ALL	LEVELER 1/2-13	401-457A
19	KR/KF12	CASTER WITH BRAKES	401-504A
	KR/KF24/36/48/74	CASTER WITH BRAKES	401-633A
20	KR/KF12	CASTER W/O BRAKES	401-503A
	KR/KF24/36/48/74	CASTER W/O BRAKES	401-634A
21	KR12	EVAP. COVER ASSY.	42B31-195D-01
	KF12	EVAP. COVER ASSY.	42B31-201D-01
	KR24	EVAP. COVER ASSY.	42B31-227D-02
	KF24	EVAP. COVER ASSY.	42B31-219D-02
	KR36/48/74	EVAP. COVER ASSY.	42B31-229D-02
	KF36/48/74	EVAP. COVER ASSY.	42B31-228D-02
22	KR/KF12	EVAP. COVER SEAL (RH)	42A31-004B-01
	KR/KF12	EVAP. COVER SEAL (LH)	42A31-005B-01

CABINET COMPONENTS (CONTINUED)
KR/KF12/24/36/48/74

ITEM	MODEL	DESCRIPTION	PART NUMBER
23	KF12	FACE HEATER (115V)	504-594B
	KF24/48/74	FACE HEATER (115V)	504-716B
	KF36	FACE HEATER (115V)	504-720B
24	KR/KF12	CABINET BREAKER (TOP & BOTTOM	60D31-119B
	KR/KF24/36/48/74	CABINET BREAKER (TOP & BOTTOM	713-051C-01
	KR/KF12	CABINET BREAKER (LEFT & RIGHT	60D31-120B
	KR/KF24/36/48/74	CABINET BREAKER (LEFT & RIGHT	713-051C-02
25	KR/KF24/36/48/74	CORNER COVER BREAKER	710-002C-01
26	KR/KF12	PILASTER (42")	403-145A
	KR/KF24/36/48/74	PILASTER (48")	403-092A
27	KR/KF12	PILASTER (MTG.) SCREWS	603-414A
	KR/KF24/36/48/74	PILASTER (MTG.) SCREWS	603-415A
28	ALL	PILASTER (HOLD) SCREWS	601-104A
29	KR/KF12	SHELF (20.25 X 18.75)	403-469A
	KR/KF24	SHELF (22.38 X 21.13)	403-323D
	KR/KF36/48	SHELF (16.125x27.375)	403-594C
	KR/KF74	SHELF (22.38 X 22.75)	403-196D
	KR/KF74	SHELF (CENTER) (22.38 X 24.3	403-197C
30	ALL	SHELF (CLIPS)	403-168A
31	KR/KF36/48	EVAP. HOUSING ASSY.	42B30-209D-02
	KR/KF74	EVAP. HOUSING ASSY.	42B30-211D-02
32	KR12	EVAP. COVER ASSY.	42B31-195D-01
	KF12	EVAP. COVER ASSY.	42B31-201D-01
	KR24	EVAP. COVER ASSY.	42B31-227D-02
	KF24	EVAP. COVER ASSY.	42B31-219D-02
	KR36/48	EVAP. COVER ASSY.	42B31-229D-02
	KF36/48	EVAP. COVER ASSY.	42B31-228D-02
	KR74	EVAP. COVER ASSY.	42B31-226D-02
KF74	EVAP. COVER ASSY.	42B31-225D-02	
33	ALL	EVAP. FAN GUARD	403-698B
34	ALL	AP. FAN BLADE 6"WHITE (4PED VAL	405-062A
35	KR/KF12	EVAP. FAN MOTOR	501-105B
	KR/KF24/36/48/74	EVAP. FAN MOTOR	501-145B
36	KR12/74	TEMP. CONTROL	502-290B
	KR24/36/48	TEMP. CONTROL	502-293A
	KF12/24/36/48/74	TEMP. CONTROL	502-147A
37	ALL	LIGHT SOCKET	503-048A--
38	KR12/24/36/48/74	LAMP 25W INCONDESANT	503-053A--
	KF12/24/36/48/74	LAMP 40 WATT INCONDESANT	503-071A
39	KF12	SWITCH (LAMP & FAN)	502-092A
40	KR/KF12	EVAP. PAN ASSY.	43B32-163C
	KR/KF24	EVAP. PAN ASSY.	43B32-248C
	KR/KF36/48	EVAP. PAN ASSY.	43B32-249C
	KR/KF74	EVAP. PAN ASSY.	43B32-250D
41	ALL	EVAP. DRAIN PAN HOOK	404-479A
42	ALL	EVAP. DRAIN PAN SPRING	404-414A
43	KF12/24/36/48/74	DRAIN LINE HEATER	504-539B
44	KF12/24/36/48/74	DEFROST TIMER	502-115A
45	KF12	TIMER WIRE ASSY.	504-313A
	KF24/36/48	TIMER WIRE ASSY.	504-750C
	KF74	TIMER WIRE ASSY.	504-738C
46	ALL	VALVE - AIR VENT	59D42-016A

**REFRIGERATION ASSEMBLY
KR/KF12/24/36/48/74**

ITEM	MODEL	DESCRIPTION	PART NUMBER
1	KR12	CONDENSING UNIT ASSY.	49B34-224D
	KF12	CONDENSING UNIT ASSY.	49B34-275D-01
	KR24	CONDENSING UNIT ASSY.	49B34-310D-01
	KF24	CONDENSING UNIT ASSY.	49B34-313D-01
	KR36	CONDENSING UNIT ASSY.	49B34-323D-01
	KF36	CONDENSING UNIT ASSY.	49B34-324D-01
	KR48	CONDENSING UNIT ASSY.	49B34-314D-01
	KF48	CONDENSING UNIT ASSY.	49B34-317D-01
	KR74	CONDENSING UNIT ASSY.	49B34-315D-01
	KF74	CONDENSING UNIT ASSY.	49B34-318D-01
2	KR12	PRESSOR 1/5HP 115-60 SIC- AEA342	302-805B
	KF12	PRESSOR 1/2HP 115-60 TEC- AJA242	302-928B
	KR24	PRESSOR 1/4HP 115-60 SIC- AEA343	302-803B
	KF24/36	RESSOR 3/4HP 115-60 COP-RS64CI	302-881B
	KR36	MPRESSOR 1/3HP 115-60 SIC-AE344	302-804B
	KR74	PRESSOR 1/2HP 115-60 TEC- AKA447	302-626B
	KF74	PRESSOR 220-50/60 CO KAKB-011E	302-927B
3	KR12	RELAY 9660-042-166	302-617A
	KF12	RELAY 3ARR3-A2M6	302-982A
	KR24	RELAY 9660-042-176	302-646A
	KF24/36	RELAY 040-0001-38	302-883A
	KR36	RELAY 9660 042 182	302-350A
	KR74	RELAY 3ARR2-KCR181S	302-290A
	KF74	RELAY 3ARR3CT24E5	314-016A
4	KR12	OVERLOAD MRP26ALL-69	302-815A
	KF12	OVERLOAD CRA4765-134	302-981A
	KR24	OVERLOAD MRP26ALL-69	302-815A
	KF24/36	OVERLOAD 071-0127-43	302-882A
	KR36	OVERLOAD MRT24AIK-69	302-911A
	KR74	OVERLOAD	302-439A
	KF74	OVERLOAD	302-979A
5	KR12	START CAP.	NA
	KF12	START CAP.	302-580A
	KR24	START CAP.	NA
	KF24/36	START CAP. 81-90 MFD @ 320V	302-885A
	KR36	START CAP.	NA
	KR74	START CAP. 378/455 MFD @125 V	302-628A
	KF74	START CAP. 014-0008-51	302-329A
6	KR12	RUN CAP.	NA
	KF12	RUN CAP. 85PR370E36 15 MFD 370V	302-983A
	KR24	RUN CAP.	NA
	KF24/36	RUN CAP. 30MFD @ 440V	302-884A
	KR36	RUN CAP.	NA
	KR74	RUN CAP.	NA
	KF74	RUN CAP.	302-980A
7	KF24/36	CAP. & RELAY ASSY. 514-1207-48	302-886A
	KR74	CAP. & RELAY ASSY. AE1227-021	302-718A
	KF74	CAP. & RELAY ASSY. 514-1211-75	317-017A

REFRIGERATION ASSEMBLY (continued)
KR/KF12/24/36/48/74

ITEM	MODEL	DESCRIPTION	PART NUMBER
8	KR12/24	DENSER FAN MOTOR (5 WATTS 11	501-019B
	KF12/24/36 KR36/48/74	DENSER FAN MOTOR (9 WATTS 11	501-148B
9	KR12/24	DENSER FAN BLADE 7.75" (3 PED A	405-012A--
	KF12/24/48-KR36/74	DENSER FAN BLADE 10" (5 PED A	405-066B
	KR48/KF74	CONDENSER FAN BLADE (8.75")	405-034A
10	KR12	CONDENSATE PAN	43B32-153B
	KF12	CONDENSATE PAN	43B35-018C
	KR24	CONDENSATE PAN	43B35-039C
	KF24/36	CONDENSATE PAN	43B35-040C
	KR36	CONDENSATE PAN	43B35-041C
	KR48	CONDENSATE PAN	43B35-035C
	KF48	CONDENSATE PAN	43B35-034C
11	KR74	CONDENSATE PAN	43B35-038C
	KR12	CONDENSER COIL (11X8X2)	305-232C
	KF12	CONDENSER COIL (11X10-7/8X4)	305-160C
	KR24	CONDENSER COIL (7-7/8X10-1/2X1-1/	305-134B
	KF24/36	CONDENSER COIL (13X12-7/8X5.563	305-346C
	KR36/48	CONDENSER COIL (11X10X3)	305-130C
	KF48-KR74	CONDENSER COIL (13-1/4X10-7/8X4	305-159C
12	KF74	CONDENSER COIL (19X10X4)	305-127C
	KR12/24/36/48	DRYER	303-126A
	KF12/24/36/48/74	DRYER	303-129A
13	KR12	EVAPORATOR COIL ASSY.	49B31-183D
	KF12	EVAPORATOR COIL ASSY.	49B31-203D-01
	KR24	EVAPORATOR COIL ASSY.	49B31-241D
	KF24	EVAPORATOR COIL ASSY.	49B31-243D-01
	KR36	EVAPORATOR COIL ASSY.	49B31-240D
	KF36	EVAPORATOR COIL ASSY.	49B31-244D-01
	KR48	EVAPORATOR COIL ASSY.	49B31-229D
	KF48	EVAPORATOR COIL ASSY.	49B31-232D-01
	KR74	EVAPORATOR COIL ASSY.	49B31-236D
14	KF74	EVAPORATOR COIL ASSY.	49B31-233D-01
	KR12	EVAPORATOR COIL (16X4X3.03)	305-342C
	KF12	EVAPORATOR COIL (16X6X4)	305-341C
	KR24	EVAPORATOR COIL (9X7X4)	305-132C
	KF24	EVAPORATOR COIL (18X7-9/32X6)	305-190C
	KR36/48/74	EVAPORATOR COIL (21X7X4)	305-129C
	KF36/48	EVAPORATOR COIL (21X7-9/32X6)	305-128C
15	KF74	EVAPORATOR COIL (35X7-9/32X6)	305-163C
	KR12-KF12	ACCUMULATOR	303-110B
	KR24/36/48/74	ACCUMULATOR	303-142A
	KF24/36/74	ACCUMULATOR	303-067A

REFRIGERATION ASSEMBLY (continued)
KR/KF12/24/36/48/74

ITEM	MODEL	DESCRIPTION	PART NUMBER
16	KR12	SUCTION AND CAP. ASSY.	49B30-215D
	KF12	SUCTION/LIQUID LINE ASSY.	49B30-190D
	KR24	SUCTION AND CAP. ASSY.	49B30-270D
	KF24	SUCTION AND CAP. ASSY.	49B30-285D
	KF36	SUCTION AND CAP. ASSY.	49B30-286D
	KR48	SUCTION AND CAP. ASSY.	49B30-259D
	KF48	SUC/LIQUID LINE ASSY	49B30-283D
	KR74	SUCTION AND CAP. ASSY.	49B30-276D
	KF74	SUC/LIQUID LINE ASSY	49B30-274D
17	KR12	CAP. TUBE .049ID X .099OD X 100	203-127A
	KR24	CAP. TUBE .042ID X .093OD X 68	203-109A
	KR36/48/74	CAP. TUBE .049ID X .099OD X 72	203-110A
	KF36	CAP. TUBE .036ID X .086OD X 72	203-140A
	KF12	EXP. VALVE FS-1/4-ZP	303-132A
	KF48	EXP. VALVE FSE-1/4-ZP	303-133A
	KF74	EXP. VALVE FSE-1/2-ZP-35	303-135A
18	KF12/24/36/48/74	DEFROST LIMIT	502-069A
19	KF12/24/36/48/74	THERMOSTAT - FAN	502-070A
20	KF12	DEFROST HEATER	504-588B
	KF24/36/48/74	DEFROST HEATER	504-672C-01
21	KF48	DISTRIBUTOR	303-103A
	KF74	DISTRIBUTOR	303-097A
22	KF12/24/36/48/74	EVAP. HEATER RETAINER	49A49-003A
23	KF48 ONLY	PRESSURE CONTROL SWITCH	502-170A